



# SEAMLESS ASCENT **UNMATCHED** **COMFORT**

Elevating Your Ride Experience.

# About company

## Bridging Today to Tomorrow: Your Partner in Elevating Possibilities.

Established in 2002, ITC Johnson Elevators is a dynamic force in the elevator industry, comprising a proficient team of 18 professionals sharing a common vision: to provide cutting-edge elevator solutions across diverse segments with a focus on professionalism. Our journey has been marked by a commitment to excellence, leveraging the expertise of our seasoned team to become a trusted name in the field. From the outset, our goal has been to revolutionize the elevator experience by combining technical prowess with a customer-centric approach.

At ITC Johnson Elevators, professionalism is the cornerstone of our operations. We prioritize transparency, reliability, and efficiency from the initial consultation to the final installation and ongoing maintenance. Elevating beyond being merely functional components, our elevators are designed to enhance the overall experience of a space, ensuring optimal performance, safety, and comfort.

Catering to a spectrum of sectors, including commercial, residential, and healthcare, we specialize in tailoring elevator solutions to meet the unique requirements of each industry. As we forge ahead, our commitment to innovation remains unwavering, with ongoing investments in research and development to stay at the forefront of technological advancements. Join us in elevating standards and experiences with ITC Johnson Elevators, where each ascent is a testament to our dedication to excellence.



## Flexibility

Flexibility is the cornerstone of adaptability, allowing us to seamlessly navigate the ever-changing landscape of challenges and opportunities.



## Installation

Effortless installation, meticulous craftsmanship – ensuring your ascent is as smooth as it is swift.



## Safety

At ITC Johnson Elevators, safety is non-negotiable. Our commitment is your assurance—elevating not just vertically, but with paramount security at every step



## Maintenance

Beyond installation, our dedicated team ensures ongoing reliability through meticulous maintenance. Trust us to keep your elevators performing at their best ensuring safety and efficiency.



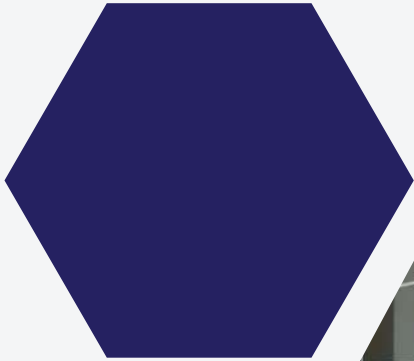

**AUTOMOBILE  
ELEVATOR**



**HOSPITAL  
ELEVATOR**



**HOME  
ELEVATOR**



**GOODS  
ELEVATOR**



**PASSENGER  
ELEVATOR**

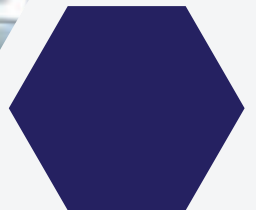



ILE  
R



HYDROLIC  
ELEVATOR



S  
OR



DUMBWAITER  
ELEVATOR







MRL  
ELEVATOR



# HYDRAULIC MACHINE

Hydraulic elevators stand as robust vertical transport solutions designed for frequent, prolonged use, boasting an exceptionally smooth ride and minimal noise. Renowned for their durability, higher weight capacities, and suitability for serving multiple floors, they are a top choice in the elevator landscape.

Operated by a hydraulic pump linked to a cylinder, these elevators raise and lower a piston to move the cab. Initiated by a call button from a higher floor, the hydraulic fluid pressurizes the cylinder, lifting the elevator.

	<b>Voltage</b> 3 phase
	<b>Suspension</b> 2:1
	<b>Brake</b> 110 VDC
	<b>Max. Static Load</b> 408 -1088 Kg
	<b>Weight of machine (Kg)</b> 117*
<p>**Weight of machine is varies according to selection of shave, Motor &amp; Drive system</p>	





## CYLINDERS APPLICATIONS EXAMPLES

CAPACITY [Kg]	TRAVEL [mm]	SPEED [m/s]	CYLINDER TYPE	Ø ROD DIAMETER	MOTOR* [Kw]	PUMP FLOW* [l/min]
250	3500	0.15	HC	70	1.5	16
480	6500	0.52	CS	80	7.7	75
630	9500	0.63	C97	100	11	150
2000	11500	0.40	C97 (tandem)	2 x 130	22	250
800	6500	0.52	2 stages Telescopic	85/2	18.4	180



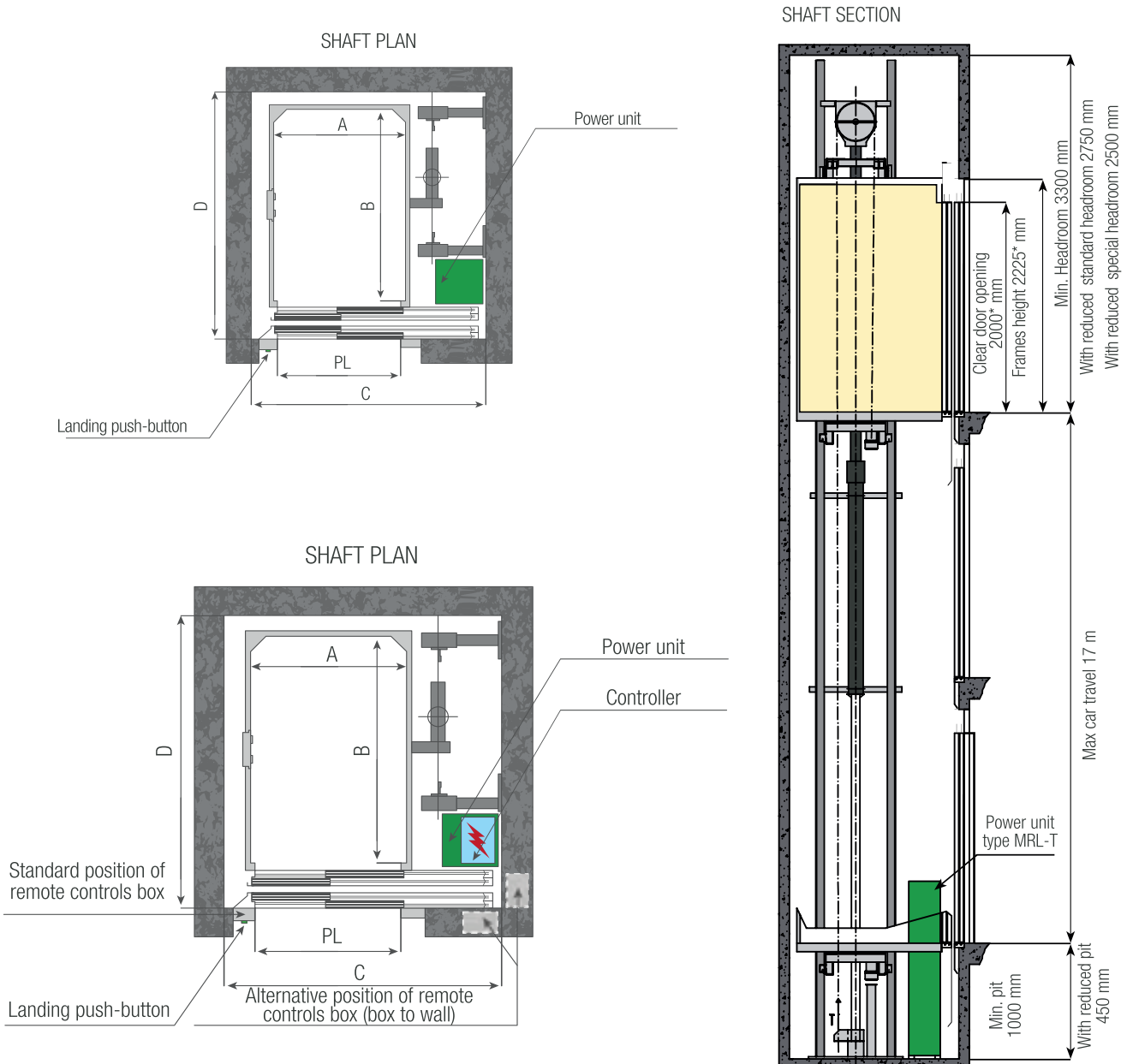

\*Indicative data, for technical details check the technical catalogue





# GEARLESS MOTOR

Explore the heart of our traction elevators with gearless machines. With direct-drive permanent magnet AC motors, these machines offer unparalleled efficiency, making them ideal for high-rises. Geared machines find their place in low-to-mid-rise buildings, combining reliable operation with a lower lifting capacity

	<b>Voltage</b> 400 V
	<b>Suspension</b> 2:1
	<b>Brake</b> 110 VDC
	<b>Max. Static Load</b> 1300-5000 Kg
	<b>Weight of machine (Kg)</b> 125*
<p>**Weight of machine is varies according to selection of shave, Motor &amp; Drive system</p>	

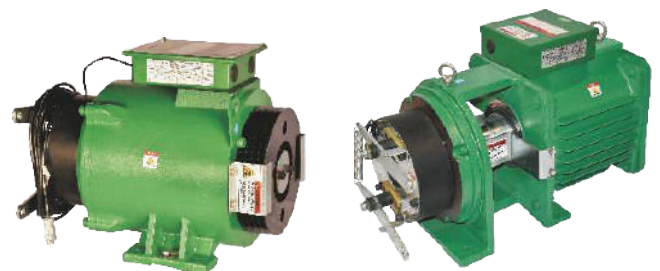





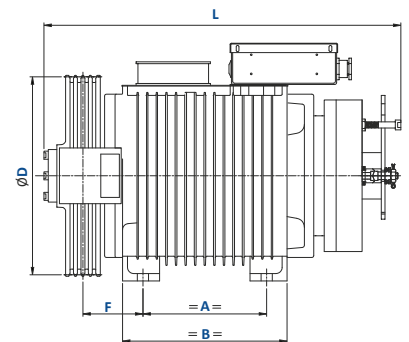
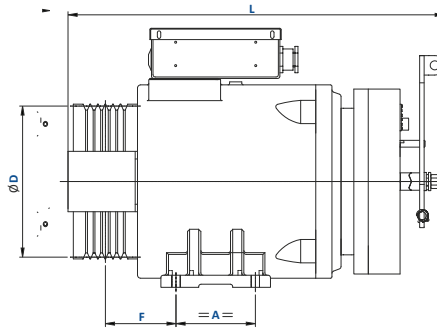
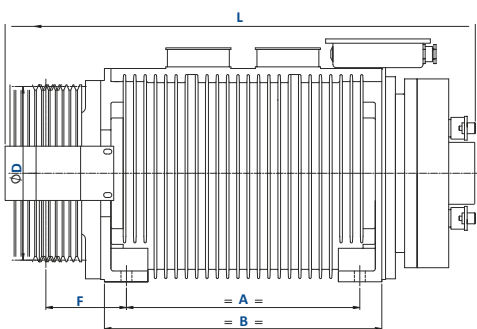
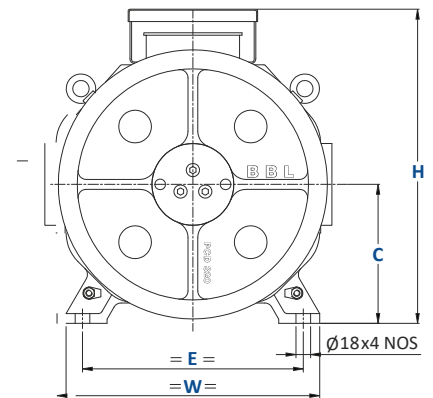
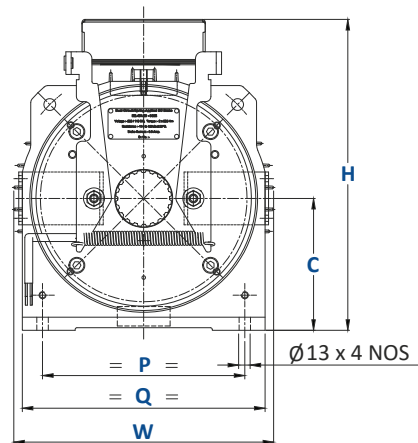
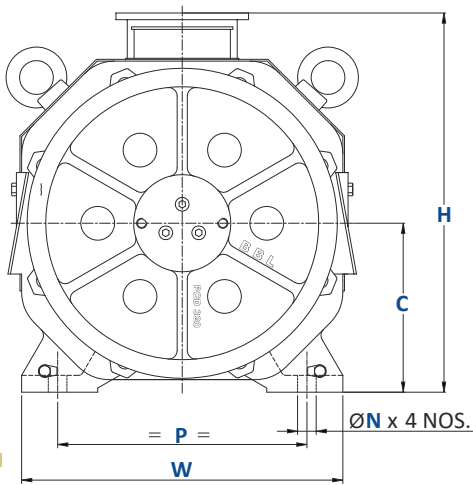

Model	GC06-320-100	GC06-320-125	GC06-320-150	GC-06-200-070	GC-06-200-100	GC-06-240-100
Duty Load (kg)	408	408	408	408	408	408
Passenger Capacity	6	6	6	6	6	6
Speed upto (m/s)	1	1.25	1.5	0.7	1	1
Sheave Diameter (mm)	320	320	320	200	200	240
Rope Diameter (mm)	8	8	8	6.5	6.5 8	6.5 8
No. of Ropes	4	4	4	4	4 4	4 4
Roping Ratio	2:1	2:1	2:1	2:1	2:1	2:1
RPM	120	150	180	133	190	160
Rated Frequency (Hz)	12	15	18	13.3	19	16
Rated Torque (Nm)	215	215	215	135	135	150
Rated Output Power (kW)	2.7	3.4	4	1.88	2.68	2.5
Rated Output Power (HP)	3.6	4.5	5.4	2.5	3.59	3.35
Rated Current (Amps)	8.5	10	11.5	7	8.5	7
Starts/Hour	120	120	180	90	120	120
Static Load (kg)	1300	1300	1300	1300	1300	1300
Machine weight (kg)	125	125	140	120	120	135





# GEARED MOTOR

Montanari gears are crafted for use in lifts and freight elevators, adhering to prevailing directives and regulations. Each gear features a ground steel worm, antifriction bronze crown, alloy steel slow shaft, and a brake with independent arms and a twin magnetic circuit. The electric motors, of in-house production, run on mineral or synthetic oils, ensuring optimal performance. The mineral oil specifications include Viscosity ISO VG 220, Flow Index 95, and EP additive. Meanwhile, synthetic oils adhere to Viscosity ISO VG 220, Viscosity Index 151, and are compatible with traces of mineral oil.

	<b>Voltage</b> 400 V
	<b>Suspension</b> 2:1
	<b>Brake</b> 110 VDC
	<b>Max. Static Load</b> 4800 Kg
	<b>Weight of machine (Kg)</b> 220kg*
<p>**Weight of machine is varies according to selection of shave, Motor &amp; Drive system</p>	



Model	Pass.	Payload (Kg.)	Sync. Speed (mps)	G. Ratio	Motor (kW)	Motor Speed (Rpm)	Poles	Current (400V) (A)	Sheave Dia (mm)	Sheave Ropes (No./mm)
MR10i	6	408	0.60*	2/55	2.7	880	6	9.2	340	6xØ8
			1.00	2/55	4.0	1500	4	12.80	340	6xØ8
* Max. lift travel 21 mtrs.										
MR10i	6	408	0.63	1/43	2.7	990	6	9.00	520	3xØ10
			0.70	1/55	3.7	1410	4	9.00	520	3xØ10
			1.00*	1/43	3.7	1590	4	9.00	520	3xØ10
* Max. lift travel 21 mtrs.										
MR10i	6	408	0.63*	1/43	2.7	990	6	9.0	520	3xØ13
			0.70*	1/55	3.7	1410	4	9.0	520	3xØ13
			1.00*	1/43	4.0	1590	4	10.0	520	3xØ13
* Max. lift travel 21 mtrs.										
MR10i	6	408	0.70*	1/55	3.7	1330	4	9.0	550	3xØ13
* Max. lift travel 21 mtrs.										

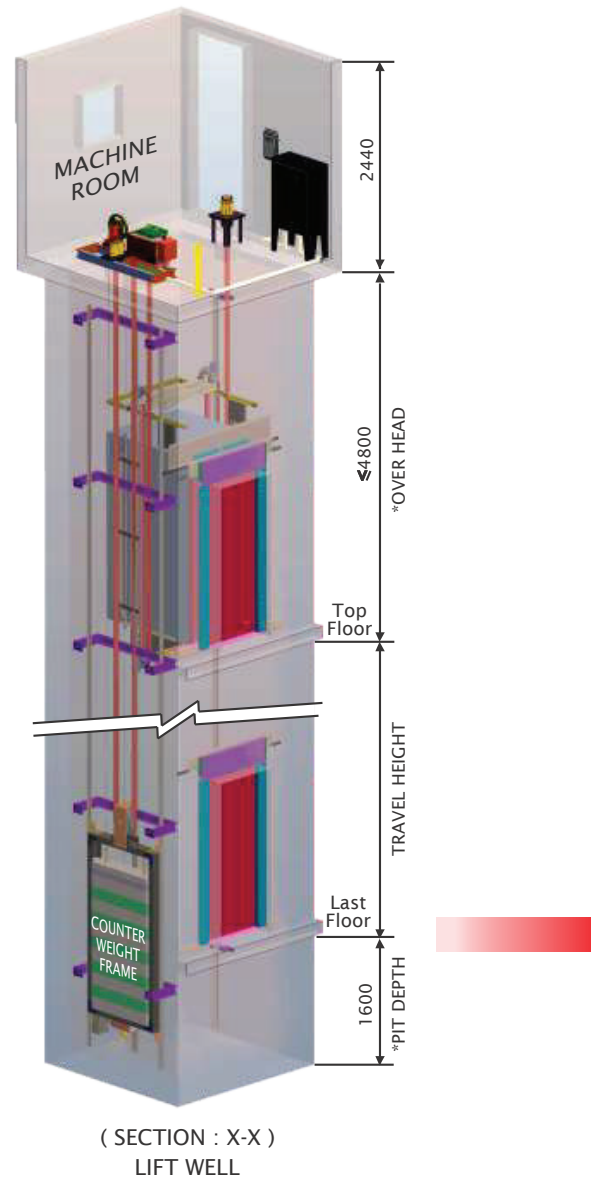
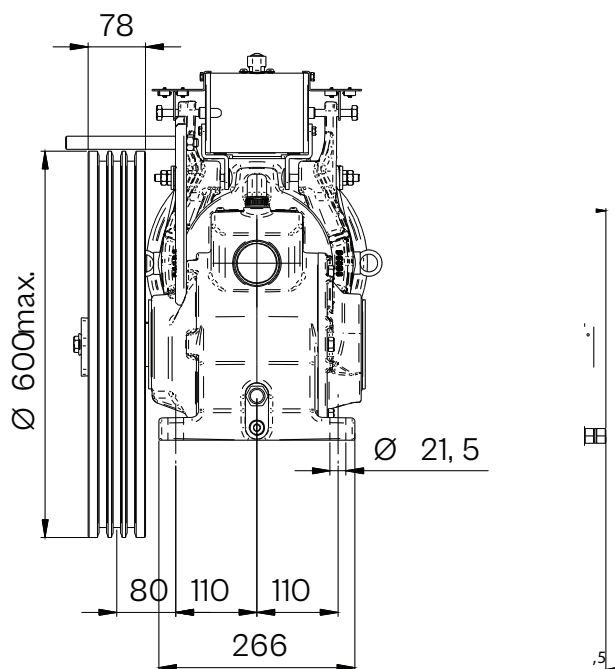
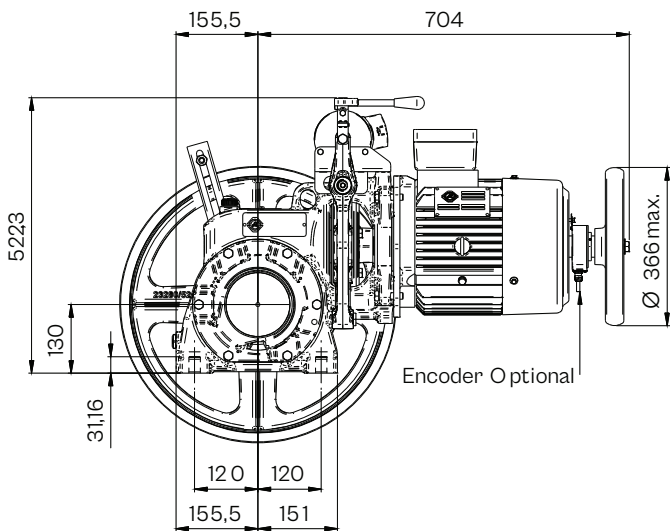





Automatic Doors-Hospital Lifts





# HOME ELEVATOR

Discover the epitome of home luxury with ITC Johnson Elevators. Our home elevators seamlessly combine elegance and accessibility, optimizing space while ensuring a whisper-quiet operation. Elevate your lifestyle with customizable designs that enhance the aesthetics of your home. Our commitment to safety, precision installation, and effortless mobility redefine the concept of elevated living. Contact us today to bring the convenience of vertical mobility to your doorstep.

	<b>Voltage</b> Single phase, 2 kw
	<b>Suspension</b> 2:1
	<b>Brake</b> 110 VDC
	<b>Max. Static Load</b> 250 kg
	<b>Weight of machine (Kg)</b> 117*
<p>**Weight of machine is varies according to selection of shave, Motor &amp; Drive system</p>	

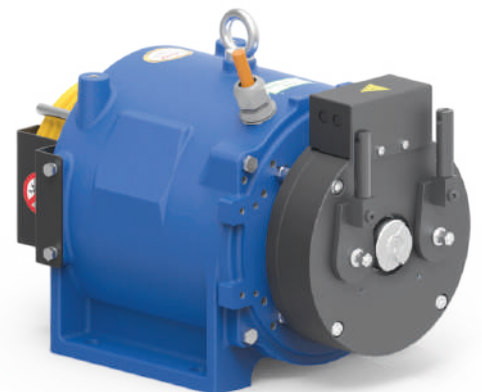

## Residential Elevators

Speed	Load		Car inside		Hoist Way		Entrance	Over Head	Pit Depth	Min Floor ht	Type of door
	Mps	Pax	Kg	CW	CD	HW					
1	4	250	900	850	1670	1550	700x2000	3700	1400	2700	AC
1	5	320	1000	950	1770	1450	700x2000	3700	1400	2700	AC
1	6	400	1000	1100	1770	1500	150x1200	3700	1400	2700	AC

\*\* All dimensions in mms

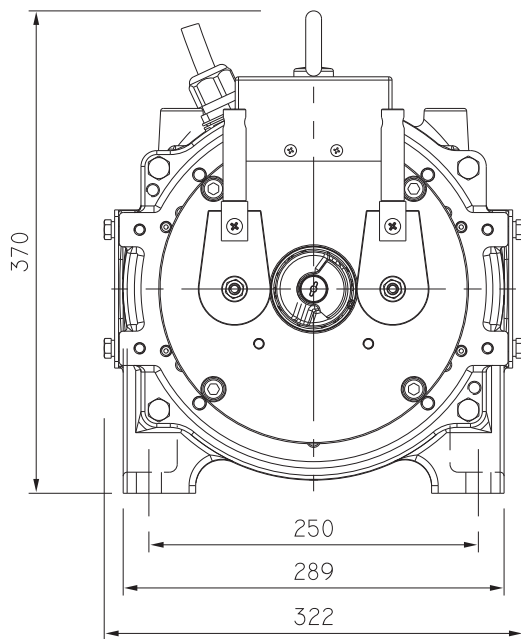

Subject to change without any prior notice!

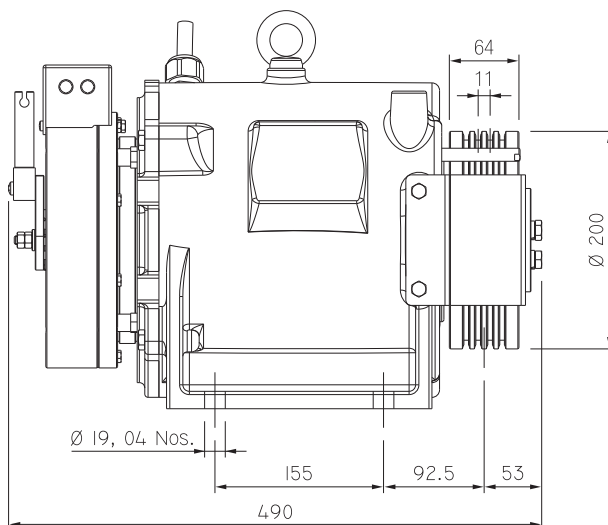



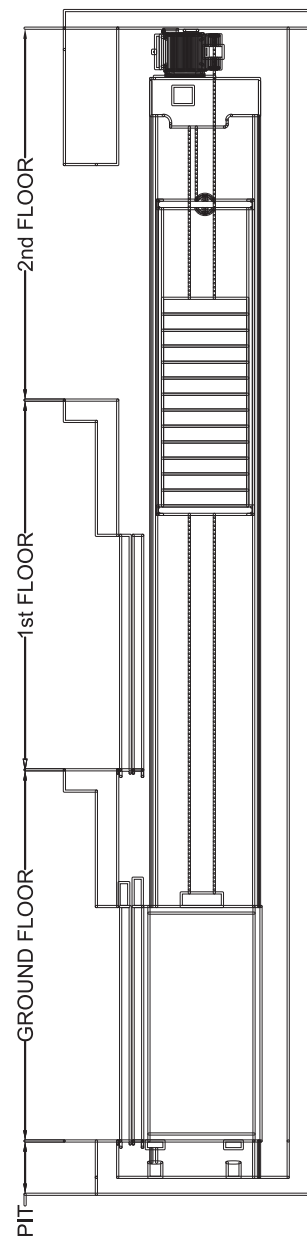

(All dimensions are in mm)





# PASSENGER ELEVATOR

Welcome to a new level of vertical transport with ITC Johnson Elevators' Passenger Elevators. Crafted for efficiency, comfort, and style, our elevators redefine the experience of moving between floors. With a commitment to safety and precision engineering, our Passenger Elevators offer a smooth and quiet ride, making each ascent a seamless journey. Whether in commercial spaces, residential complexes, or healthcare facilities, our elevators are designed to elevate the way people move, ensuring a reliable and sophisticated means of vertical transportation.

	<b>Voltage</b> 3 phase
	<b>Suspension</b> 2:1
	<b>Brake</b> 110 VDC
	<b>Max. Static Load</b> 408 kg
	<b>Weight of machine (Kg)</b> 139*
<p>**Weight of machine is varies according to selection of shaft, Motor &amp; Drive system</p>	

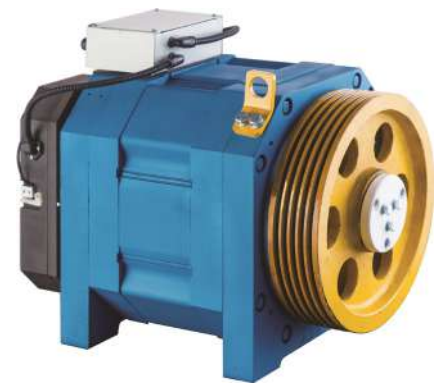



## Passenger Elevators

Load		Car inside		Lift Well		Entrance	Machine room		Type of doors
Persons	Kg	A	B	C	D	E	K	L	
4	272	1100	700	1000	1100	500	3100	3600	Manual
5	340	1100	900	1600	1300	800	3100	3500	Manual
6	408	1100	1000	1600	1400	600	3100	3900	Manual
8	544	1300	1100	1800	1560	800	3300	405	Manual
4	272	1100	700	1600	1350	700	3100	3650	Automatic
5	340	1100	900	1600	1500	700	3100	4000	Automatic
6	408	1100	1000	1900	1600	800	3400	400	Automatic
8	544	1300	1100	1900	1900	800	3400	4400	Automatic
10	680	1350	1300	1900	2100	800	3400	4600	Automatic
13	884	2000	1100	2500	1900	900	4000	4400	Automatic
16	1085	2000	1300	2500	2100	1000	4000	4600	Automatic
20	1360	2000	1550	2500	2400	1000	4000	4900	Automatic
26	1768	2100	1800	2600	2500	1100	4200	5000	Automatic

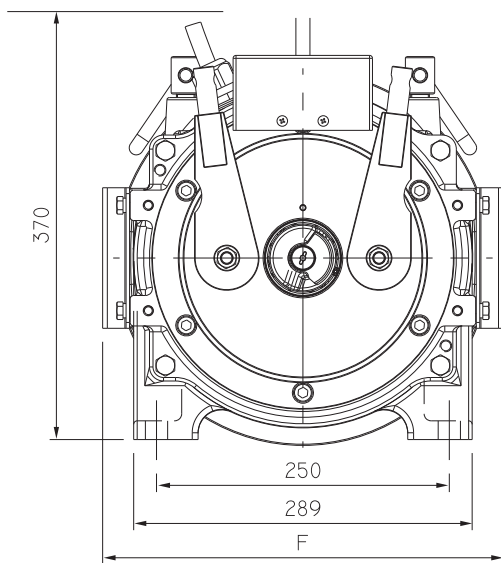

Subject to change without any prior notice!

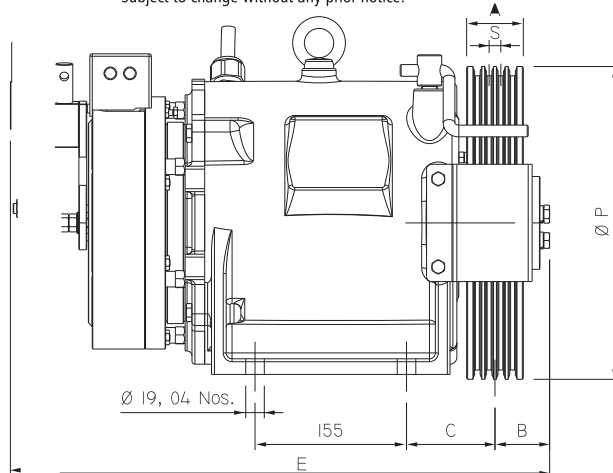



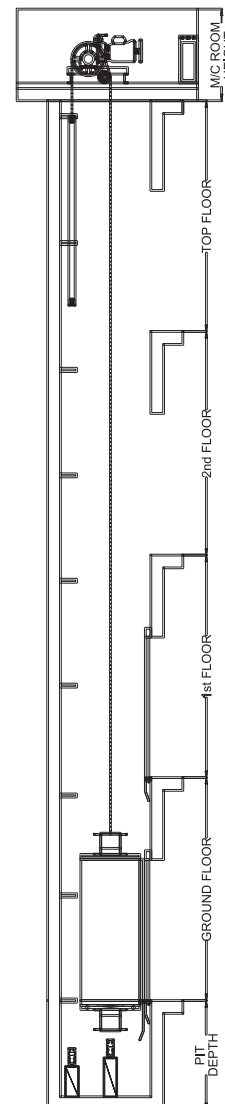

(All dimensions are in mm)





# HOSPITAL ELEVATOR

ITC Johnson Elevators introduces a specialized solution for healthcare environments with our Hospital Elevators. Engineered with the utmost precision and a deep understanding of the unique demands within medical facilities, our elevators prioritize efficiency, hygiene, and patient comfort. With advanced safety features and a commitment to seamless vertical mobility, our Hospital Elevators ensure swift and reliable transportation for patients, staff, and medical equipment.

	<b>Voltage</b> 3 phase
	<b>Suspension</b> 4:1
	<b>Brake</b> 110 VDC
	<b>Max. Static Load</b> 1020 - 1788 kg
	<b>Weight of machine (Kg)</b> 600* (with bed plate)
<p>**Weight of machine is varies according to seleciton of shave, Motor &amp; Drive system</p>	

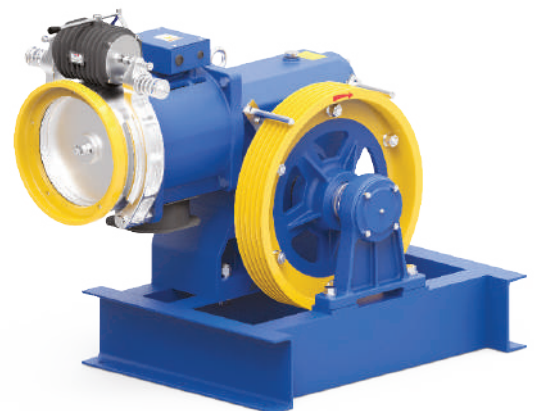
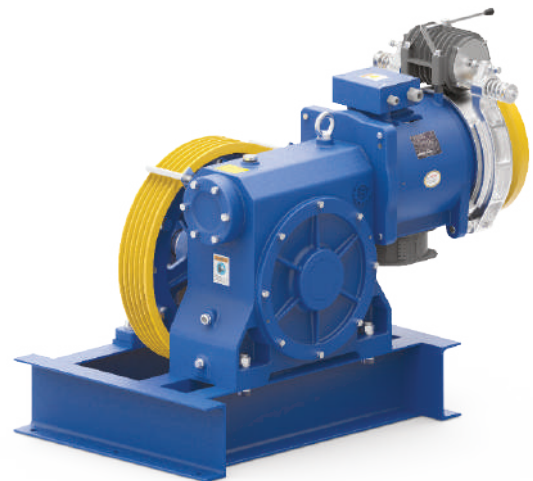

## Goods Elevators

Load	Car inside		Lift Well		Entrance	Macine room		M/c Room Hgt
	A	B	C	D		K	L	
800	1550	1500	2000	2000	900	2500	4500	2500
1000	4100	1800	2300	2100	1400	2500	4600	2500
1500	1700	2000	2600	2300	1700	2600	4800	2500
2000	1700	2500	2600	2800	1700	2600	5300	2500
2500	2000	3000	2800	2700	2000	2900	5800	2500
3000	2000	3000	2900	3300	2000	2900	5800	2500
4000	2500	3000	3400	3300	2500	3400	5800	2500
5000	2500	3600	3400	3900	2500	3400	6400	2500

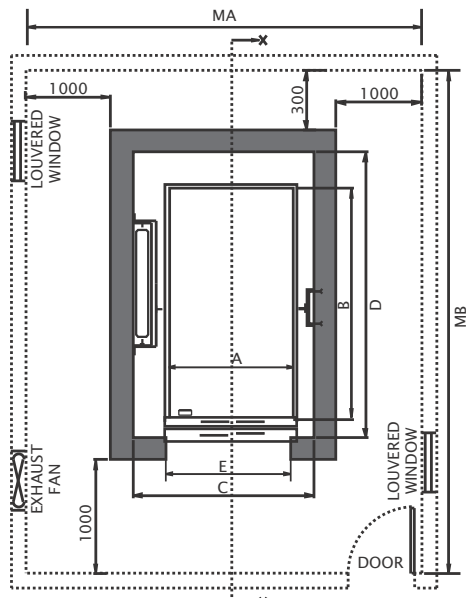

LIFT SHAFT, CAR, C.W. & MACHINE ROOM PLAN

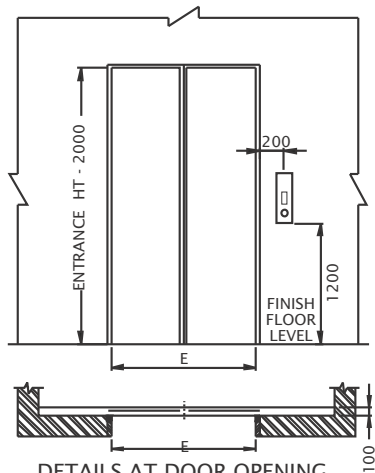

DETAILS AT DOOR OPENING

(All dimensions are in mm)

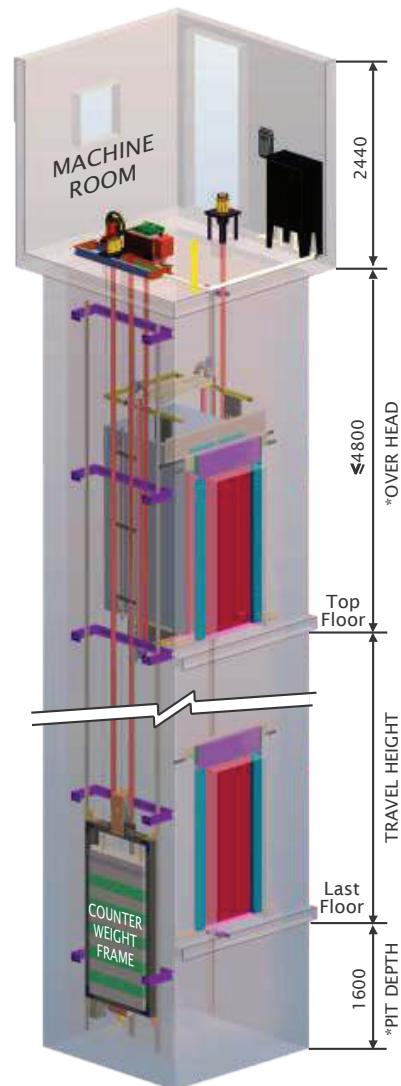

( SECTION : X-X )  
LIFT WELL

### Automatic Doors-Hospital Lifts







# GOODS ELEVATOR



ITC Johnson Elevators proudly presents our Goods Elevators, designed to meet the diverse vertical transportation needs of industrial and commercial spaces.

Engineered for durability and efficiency, our Goods Elevators are built to handle heavy loads with ease, making the movement of goods within your facility a seamless and efficient process. With a robust design, advanced safety features, and a focus on optimizing logistical workflows, our Goods Elevators are the trusted choice for businesses looking to enhance productivity and streamline material handling. Elevate your logistics with ITC Johnson Elevators, where reliability and performance meet in every ascent.

	<b>Voltage</b> 3 phase
	<b>Suspension</b> 4:1
	<b>Brake</b> 110 VDC
	<b>Max. Static Load</b> 408 - 1088 kg
	<b>Weight of machine (Kg)</b> 245*
<p>**Weight of machine is varies according to selection of shave, Motor &amp; Drive system</p>	

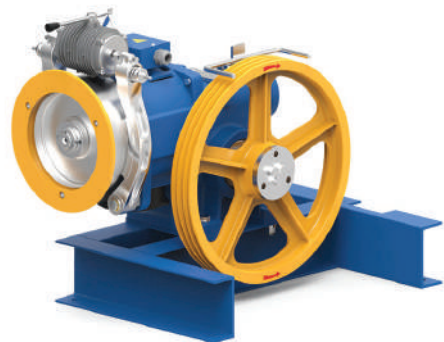

## Goods Elevators

Load	Car inside		Lift Well		Entrance	Macine room		M/c Room Hgt
	A	B	C	D		K	L	
Load in Kg	A	B	C	D	E	K	L	
800	1550	1500	2000	2000	900	2500	4500	2500
1000	4100	1800	2300	2100	1400	2500	4600	2500
1500	1700	2000	2600	2300	1700	2600	4800	2500
2000	1700	2500	2600	2800	1700	2600	5300	2500
2500	2000	3000	2800	2700	2000	2900	5800	2500
3000	2000	3000	2900	3300	2000	2900	5800	2500
4000	2500	3000	3400	3300	2500	3400	5800	2500
5000	2500	3600	3400	3900	2500	3400	6400	2500

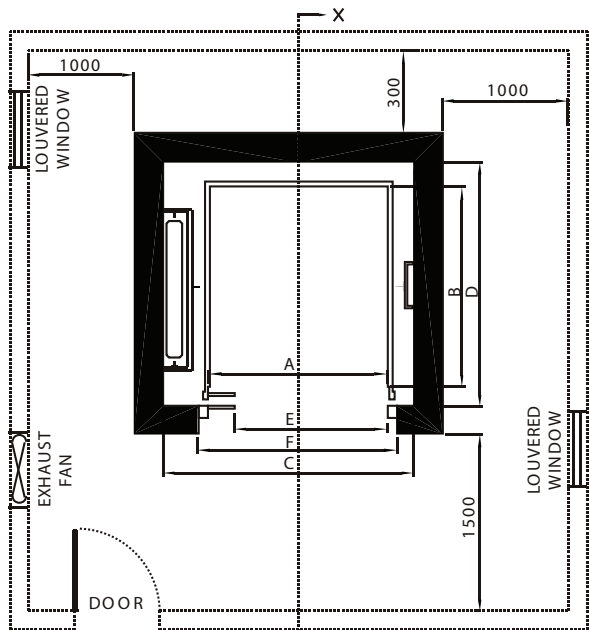

LIFT SHAFT, CAR, C.W. & MACHINE ROOM PLAN

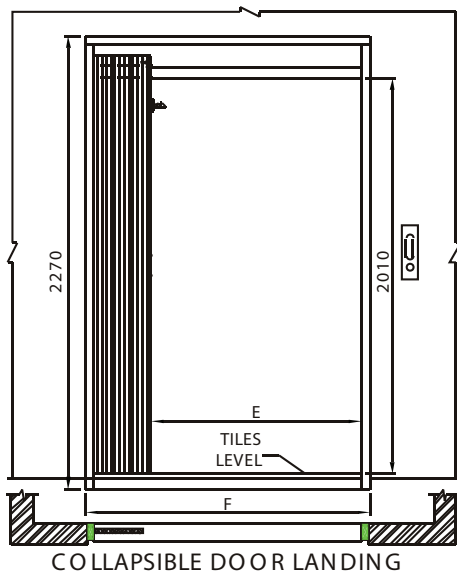

COLLAPSIBLE DOOR LANDING

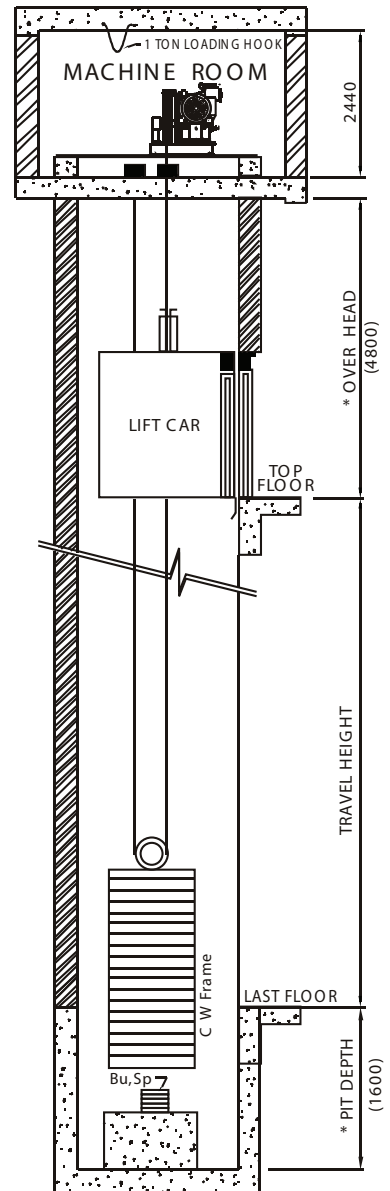

( SECTION : X-X ) LIFT WELL  
Std. Speed - 0.35 m/s

# CAR DOORS DESIGNS

Lift car door designs by ITC Johnson Elevators combine functionality with aesthetics, offering a seamless blend of style and efficiency. From sleek, modern finishes to customizable options, our lift car doors are crafted to enhance the visual appeal of your space. Experience innovation in every detail, as our diverse range of lift car door designs reflects our commitment to elevating both form and function.



**Ivory Collapsible  
Doors**



**S.S Steel Half Vision  
Auto Door**



**S.S Steel Big Vision  
Auto Door**



**S.S Steel Small Vision  
Swing Door**



**S.S Steel Manual  
Telescopic Big Vision**



**M.S Swing Door**



**M S Zig Zag Swing Door**



**M S Long Vision  
Swing Door**



**M.S Big Vision  
Swing Door**



**M.S (1Big Vision+3  
Small Vision) Swing  
Door**



**M.S Small Vision  
Manual Telescopic  
Doors**



**Imperforated  
Doors**

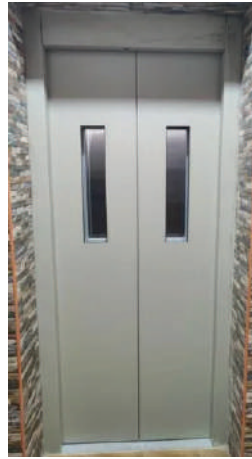

**M.S Small Vision  
Auto Door**



**M.S Half Vision  
Swing Door**



**M.S Small Vision Round  
Design Swing Door**



**S.S Steel Small  
Vision Auto Door**

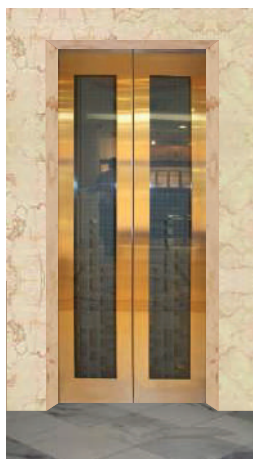

**Gold Mirror S.S Big  
Vision Auto Door**



**Black Mirror S.S Big  
Vision Auto**



**Rose Gold Mirror S.S  
Big Vision Auto Door**



**M.S Long Vision Side  
Swing Door**

# EXTENSION SPECIFICATIONS FOR DOOR DESIGN



# EXCLUSIVE CABIN DESIGNS

Experience elevated luxury with our exclusive cabin designs tailored for you. From refined aesthetics to ergonomic excellence, our cabins are crafted to enhance your journey. Step into a realm of personalized elegance with ITC Johnson Elevators, where user-centric design meets unparalleled style.



**Designer Cabin Rx**



**Plain S.S Steel Cabin  
with Fall Ceiling Designer**



**MX Designer Cabin**



**Designer Cabin Rx**



**Dx Designer Cabin**



**Qx Designer Cabin**



**Glass Designer Cabin**

# CAR OPERATING PANEL & HALL BUTTON STATION

Discover seamless control and accessibility with ITC Johnson Elevators' state-of-the-art Car Operating Panel and Hall Button Station. Engineered for user-friendly operation, our intuitive control interfaces redefine the elevator experience. The Car Operating Panel ensures a smooth and responsive journey within the elevator, while the Hall Button Station facilitates effortless floor selection from outside the cabin. Elevate your control with precision and convenience, as our cutting-edge technology sets a new standard for efficiency in vertical transportation.





# CELLING DESIGN

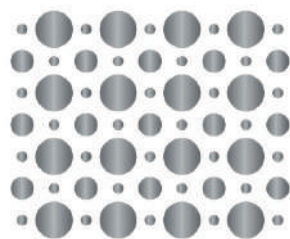
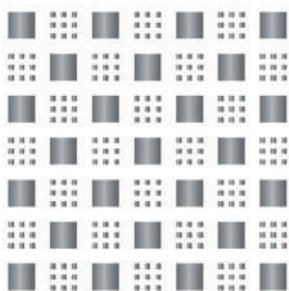
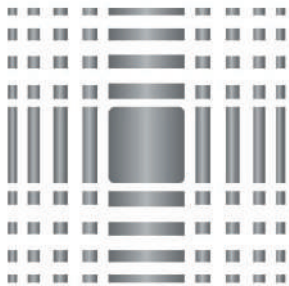

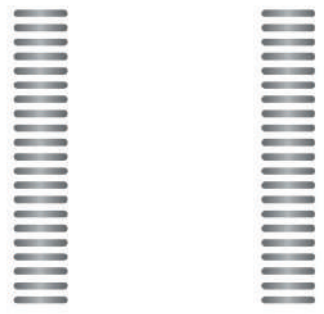
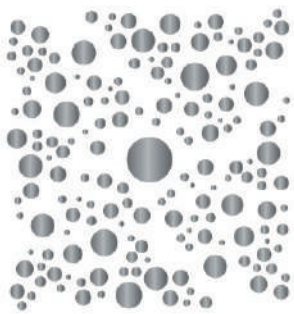
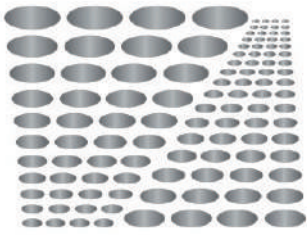



# CONTROLLER

At the heart of our elevator systems lies the advanced Controller by ITC Johnson Elevators. Seamlessly orchestrating the precision and efficiency of every ascent and descent, our state-of-the-art controller is a testament to innovation. Meticulously engineered for reliability, safety, and optimal performance, it ensures a smooth and secure ride experience. Trust in the intelligence of our controller technology as we redefine the standards for efficient vertical transportation, making each journey with ITC Johnson Elevators a seamless and sophisticated experience.



# FLOORING

ANTI SKID PVC FLOORING WITH CHOICE OF COLOUR & DESIGN

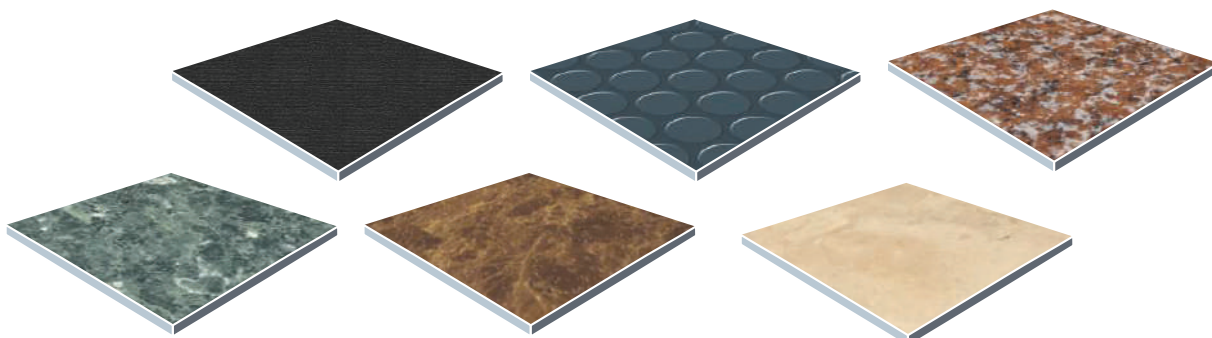

# SAFETY FEATURES

SAFETY FEATURES			
COMFORT FEATURES	DESCRIPTION	S	O
Adjustable Open-Door	The door's operation time (opening & closing) are adjustable, depending on whether the stop was called from the hall or the car, to allow smooth boarding or loading.	•	•
Animated Display	Dot Matrix display is installed at the COP to show the current floor, travelling direction, and customized message.	•	•
Anti-nuisance at Light-load	If the numbers of registered car calls do not correspond to the carload, all calls are cancelled to avoid unnecessary stops.	•	•
Attendant Service	When a car is operated by an attendant, it allows for the car to be driven by controlling the COP on travel direction and/or by-passing ride.	•	•
Automatic Bypass	A fully-loaded car (usually at 80% of the rated load) bypasses hall calls in order to maintain maximum operational performance.	•	•
Automatic Fan & Lighting Power in Car	If there are no calls for a certain period, the car ventilation fan & lighting will automatically be turned off for energy saving.	•	•
Automatic Parking	If there are no calls for a specified period, the car will automatically return to the main landing.	•	•
Automatic Door Open & Close	If the car is within the door zone, the door will automatically open and it will close after a period of time.	•	•
Car-call Cancellation	Passengers can cancel the wrong registration by pressing the same button twice.	•	•
Car Alarm Bell	Ring bell for emergency used during distress in the car.	•	•
Call Cancelled When Reverse Direction	When a car has responded to the final car call in one direction, the system regards remaining calls in the other direction as errors and clears the memory.	•	•
Direct Landing	In analogue, given curve control system slows down the lift at a distance for a smooth landing.	•	•
Emergency Illumination in Car	Emergency lighting illuminates automatically during a power failure.	•	•
Full Collection Operation	Lift stop in response to the car call, a passenger can register his or her call at any landing.	•	•
Full Height Sensor	Infrared-light beams cover the car height of the doors and are used to detect passengers or objects before doors close.	•	•
Hall Call for Door Opening	Closing doors can be reopened by pressing the hall button corresponding to the same travelling direction of the car.	•	•
Overload Protection	When functioning, the doors remain open and the car does not move with alarm buzzing on until enough passengers exit the car.	•	•

ELEVATED EXCELLENCE, UNWAVERING DEDICATION.



## ITC JOHNSON ELEVATORS

**Office:** H.No: 11-10/1, Alwal, 4th Floor, Aboce Spencer's Super market, Secunderabad-500010. Telangana.

**Manufacturing Unit:** # A-14, N.H. No.8, Nr. Robari Colony, Amaraiwadi, Ahmedabad-26 (Gujarat).

**Contact No : 9966384777 , 6300715908**

- ✉ [Info@itcjohnsonelevator.com](mailto:Info@itcjohnsonelevator.com)
- ✉ [ItcJohnsonelevator@gmail.com](mailto:ItcJohnsonelevator@gmail.com)
- 🌐 [www.itcjohnsonelevator.com](http://www.itcjohnsonelevator.com)